

FOR INTERNAL PURPOSES ONLY



Scrubmaster B115 R vs. B120 R



Working widths

B120 R

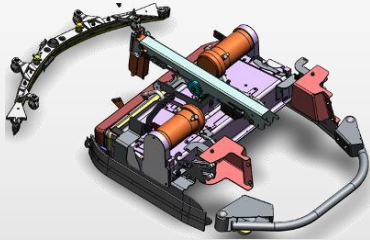

4 working widths

Disc brush unit

- 750 mm
- 900 mm

Cylindrical brush unit
with sweeping function

- 700 mm
- 850 mm

TB650 → B75 R

B115 R



5 working widths

Disc brush unit

- 650 mm
- 750 mm
- 900 mm

Cylindrical brush unit
with sweeping function

- 700 mm
- 850 mm

Solution and recovery tank

B120 R



Capacity: 120 litres
(the machine's
dimensions are the
same as those of the
B115 R)

B115 R



Capacity: 115 litres

Configuration options

B120 R

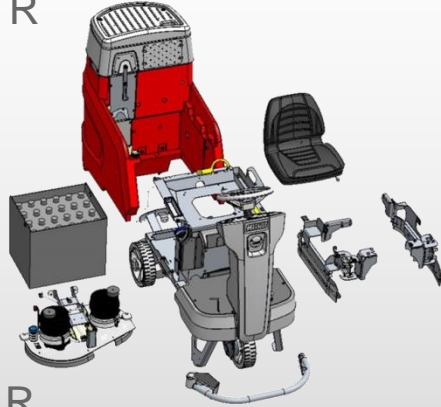

Custom-configured version
+ 3 customer-neutral editions
(available from stock)

B115 R



5 specified versions

Operating panels

B120 R



One operating panel, similar to B75 R

B115 R



Two operating panels

Recovery tank

Solution tank

B120 R

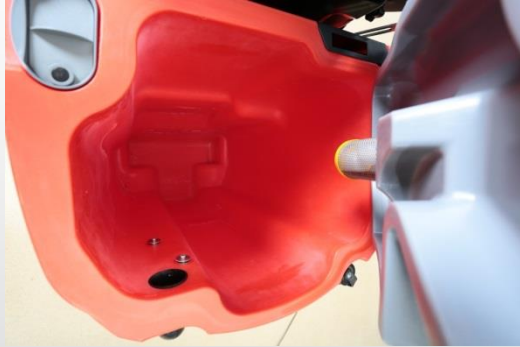

Recovery tank with smooth inner walls and no undercuts enables easy cleaning

B120 R



Larger opening incl. sieve
→ Automatic filling system (optional)

B115 R



B115 R



Incorrect filling, vacuum connection piece

Emptying the solution tank

B120 R



Draining of the water through the suction hose docked to the fresh water filter. Dosing through the shut-off valve.



B115 R



Draining through the fresh water hose.

On-board dosing system

B120 R



Integrated in the machine design

B115 R



In the foot area

Tank cover

B120 R



-Suction turbine integrated → short suction path provides a powerful suction
- folds to the side

B115 R



-Suction turbine not integrated → long suction path

Changing of brushes

B120 R



Fold-out side bumper strips allow fast and easy changing of brushes

B115 R



Hooked-in side bumper strips

Additional features Scrubmaster B120 R

B120 R



Illuminated display

B120 R



Warning signal / display indicating when the water level in the solution tank drops below 10 litres

B120 R



Slow-Mode:
Working speed can be reduced to a maximum 3.5 km/h to provide both efficient and controlled cleaning

B120 R



Solution tank with large revision opening allows comfortable cleaning of the tank

Additional features Scrubmaster B120 R

B120 R

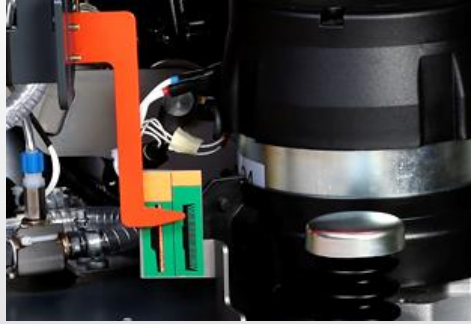

Indicator for missing or worn brushes

→ for consistently good cleaning results

B120 R



Shut-off valve before the fresh water filter, enables cleaning the tank without draining it first

B120 R



The squeegee can be hooked in the squeegee holder

B120 R



Flashing light on a rod (optional)

Additional features Scrubmaster B120 R

B120 R



LED warning system rear (optional)



LED work light front (optional)

B120 R

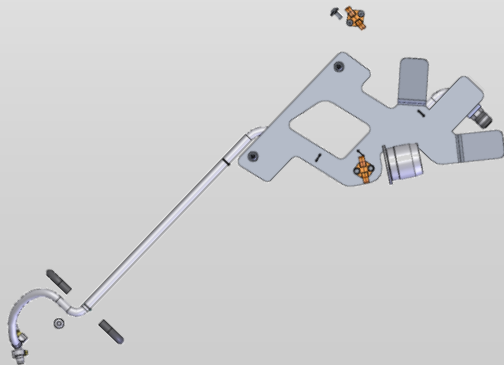

Basic bracket for additional tools, can be upgraded (optional)

- Spray/vacuum tool
- Hand vacuum tool
- Mop
- Spray nozzle

B120 R

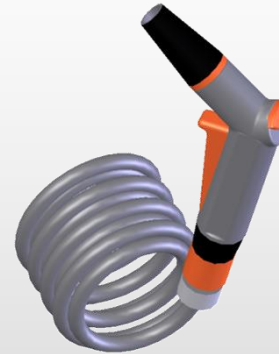

Spray nozzle to clean the recovery tank (optional)

B120 R



Ergonomic steering wheel providing a perfect view onto the operating elements. Optionally available with a steering wheel knob

Additional features Scrubmaster B120 R

B120 R



Country-specific mains plug / on-board charger with IEC socket

B120 R

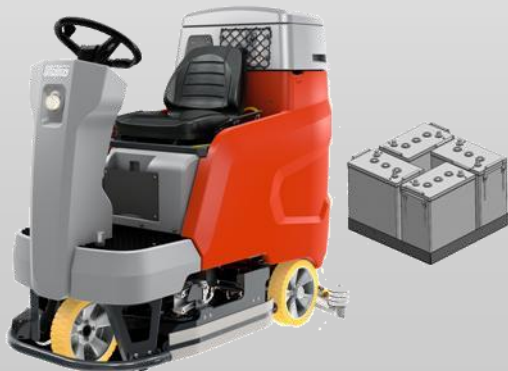

Battery is included in the ex works scope of supply +
Other editions available from stock
→ Short delivery time

B120 R

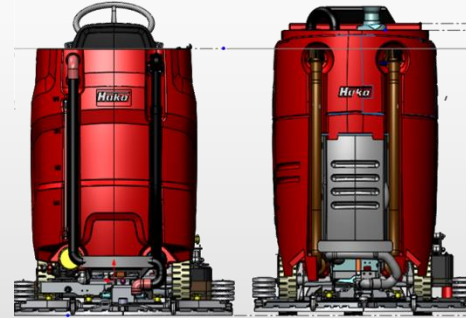

The height of the recovery tank is reduced by 80 mm

→ makes cleaning the tank more comfortable

B120 R



The workplace has been designed to provide healthy sitting which increases the operator's efficiency.

Options

B115 R



- Storage basket
- Mop holder incl. bracket
- Hand vacuum tool without bracket
- Driver's seat, comfort
- On-board dosing system
- Coarse dirt sieve for the recovery tank
- Spray/ vacuum tool
- Hako-Fleet-Recorder
- Work light at the front
- Warning system at the front

B120 R



- Power cable, country-specific
- Storage basket
- Mop holder incl. bracket
- Driver's seat, comfort
- Hand vacuum tool incl. bracket
- On-board dosing system
- Spray nozzle incl. bracket
- Automatic filling system
- Holder for spray/vacuum tool
- Coarse dirt sieve for the recovery tank
- Spray/ vacuum tool
- Steering wheel knob
- Hako-Fleet-Recorder
- LED work light at the front
- Warning system at the front
- Warning system at the rear
- Flashing light on a rod